

## Setting up a Desk

Jack Yumulu - 2023-01-17 - Comments (0) - Desk Setup

# Setting up a Desk

The below How-To guide will be showing you how to set up a desk at home, please note for this example I have used our most popular setup. (Which is a Lenovo Laptop and Dock)

## **Step 1: Firstly, unbox everything**

## **Step 2: Connecting USB-C Cable to Lenovo Dock:**



**Step 3: Plug in the power cable for the  
Lenovo dock:**



**Step 4: Plug in the USB cables to the Lenovo dock (etc Keyboard and Mouse):**



**Step 5: Plug in the HDMI cable into the monitor**



Laitte on liitettävä suojakoskettimilla varustettuun pistorasiaan.  
L'appareil doit être branché sur une prise de courant munie d'une mise à la terre.  
The equipment must be connected to an earthed mains socket-outlet.  
Apparatet må tilkoples jordet stikkontakt. Apparaten skall anslutas till jordat uttag.  
Apparatets stikprop skal tilsluttes en stikkontakt med jord.  
som giver forbindelse til stikproppens jord.  
Avertissement : Une utilisation excessive peut potentiellement endommager votre vue.  
Warning: Excessive use might result in vision damage.  
This device complies with part 15 of the FCC Rules.  
operation is subject to the following two conditions:  
) this device may not cause harmful interference, and  
) this device must accept any interference received,  
including interference that may cause undesired operation.

Icons and labels on the device's back panel:

- CE mark
- FCC mark
- Intertek mark
- RoHS mark
- WEEE mark
- Energy Star mark
- Recycling symbol
- Other regulatory symbols

Model number: H005-20

Manufacturer information: Shenzhen Zhongshan Zhongshan Co., Ltd. (in Chinese)

## Step 6: Plug in the power cable into the monitor



**Step 7: Plug in the HDMI cable into the Lenovo Dock from the Monitor**



**Step 8: Connect your laptop to the USB-C cable from the dock**

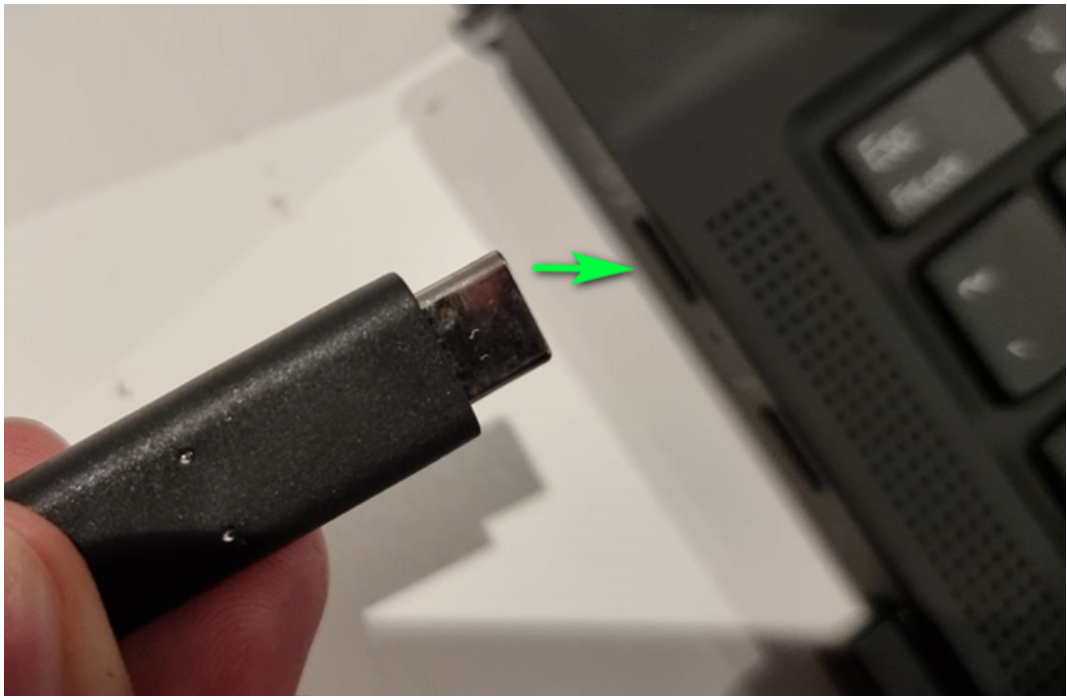



**Step 9: TA DA you are all done! (Should look something like this!)**



If you require assistance please contact the I.T Team, either through the intranet (<https://helpdesk.sen.com.au>) or by emailing SEN Helpdesk ([helpdesk@sen.com.au](mailto:helpdesk@sen.com.au)).

**Attachments**

- [How-To-Setup-a-desk-Guide.pdf \(483.39 KB\)](#)